

We manage water- flows.

Swiss precision, spirit of innovation and art of engineering unifying design and functionality.

Know-how
from
Switzerland

Since the day it all began in 1874 in Switzerland, we have been defined by our experiences. Geberit has been among the pioneers of the industry and is still setting trends with comprehensive system solutions.

With approximately 6,000 employees around the world and offices in more than 40 countries, Geberit stands for innovation, durability and ecological efficiency.

1874 Caspar Melchior Albert Geberit (1850–1909) opens a plumber's shop in the Old Town of Rapperswil (CH). At the turn of the century, his two sons Albert Emil and Leo join the company and start the production of wooden flushing cisterns.

1905 Albert Emil Geberit succeeds in producing the first wooden flushing cistern that is lined with lead and equipped with leaden fittings, under the brand name "Phoenix".

1952 The first PVC flushing cistern is produced.

1964 Introduction of the first concealed cistern.

1999 In the year of the 125th anniversary of the company's founding, Geberit succeeds in being listed on the stock market.

2004 Geberit takes over the German Mapress Group, the largest acquisition in company history.

2005 Formation of Geberit International Sales AG.

2010 The newly established Asia/Pacific headquarters in Shanghai as well as the European Geberit Logistics Centre in Pfullendorf (DE) are inaugurated and put into operation.



GEBERIT GEBERIT

 GEBERIT

→ **Why a complete Geberit system offers so many advantages.**

Learn more on page 8 and the following pages describing our products.





→ **Why a concealed cistern.**

Learn more on page 9,10 and 13.

Concealed solutions offer more space in your bathroom and give it a modern look.



→ **Why wall-mounted toilets are so convenient.**

Learn more on page 9 and 10.





→ **Why sustainable systems and products are smart in both the short and long term.**

Learn more on this topic within the product descriptions.

Sustainable products include not only eco-friendly production, but also commitment to social issues and fairness in business relation. Geberit offers the highest standards of environmental friendliness, resource saving and durability in its products.

From beginning to end.

Geberit systems deliver solutions for water supply, use and drainage.

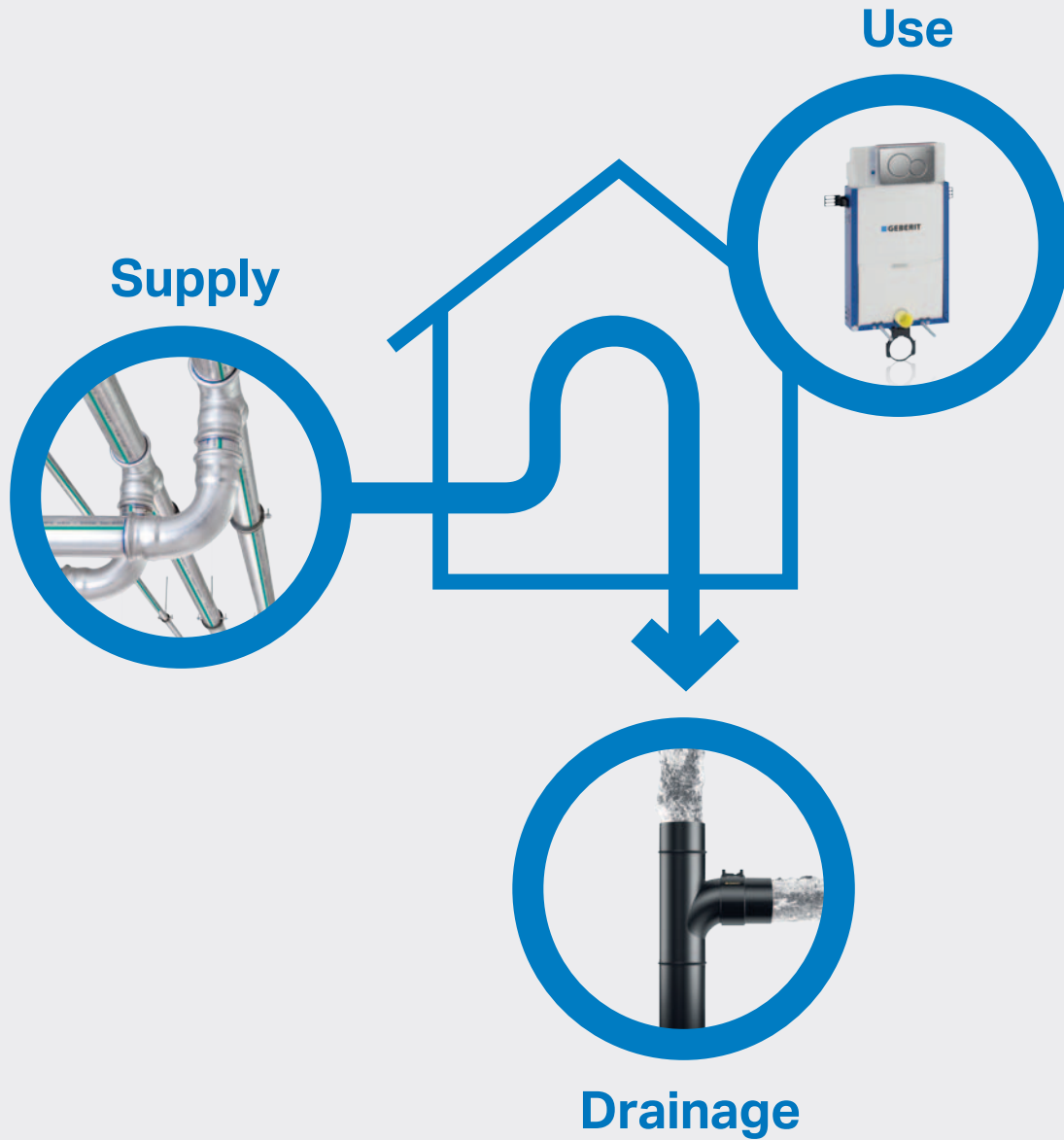

Supply

Geberit supply systems are easy to install, have high pressure and temperature resistance and low noise transmission.

Use

Geberit sanitary systems have continually set trends for more than 125 years.

Drainage

Geberit waste and drainage systems cover solutions for domestic, industrial and commercial applications.

Why concealed and wall-hung?

With Geberit installation systems, the pipes, cisterns and the connections are no longer visible but hidden within the Geberit preWall installation.



★★★★ Premium quality

The benefits of a concealed preWall installation is no longer water and drain connections that determine the position of the WC or urinal, but the optimal design and planning of the room. New partition walls and the wall-hung system give you a free reign with any bathroom design. A bathroom with concealed installations will feel more spacious than a conventional bathroom, showing elegant beauty from floor to ceiling.

Concealed installations are more hygienic because they offer clean lines and clear surfaces. Therefore, they are extremely easy to clean. The wall-hung toilet makes it possible to clean the entire floor beneath the toilet. There is no risk of the toilet coming away from the wall as the construction is able to bear a weight of 400 kg.

👁️ Modern bathroom design

💧 Reduced water costs due to dual flush

🚪 Optimisation of space for an improved interior feeling

🧹 Easy cleaning, no obstacles on the floor

🏗️ Construction withstands weights of 400 kg

🔧 Accessibility at any time

Solutions for modern bathrooms.

Everything for a working sanitary system.



Geberit Kombifix

Solid as a rock

For solid constructions Geberit Kombifix is the right product to be used. It has good noise reduction qualities, is extremely reliable and is designed to carry weights up to 400 kg. The Geberit Kombifix installation element is installed directly into the wall. For installation before the brick wall is built up, the Kombifix element is set on feet and the wall is built around it. For installations in a space inside the wall, the gaps around the Kombifix element are filled with bricks to support the element.

Main reasons to go for Geberit Kombifix:

- For solid and brick wall
- For renovating existing bathrooms
- For new buildings
- Large flush adjustable to 4.5 l
- 25 years guaranteed spare parts availability

Geberit Duofix

Framed functionality

The fastest installation solution is Geberit Duofix. It is a universal installation element that can be placed either inside or in front of a dry wall, as well as in front of solid constructions. As a preWall element, the Geberit Duofix is ideal due to its stability. No bricks are needed. Its height, the integrated feet, as well as its depth, are very easy to adjust, therefore simplifying the installation even more. With the wall fastening set, the self-supporting Duofix frame is fastened to a solid wall, where it remains firmly anchored, when covered with panels.

Geberit Duofix offers the following possibilities:

- Simple and fast installation, therefore cost-saving
- Structural walls are not influenced
- For new construction and renovation
- Pre-assembled and self-supporting
- For dry wall constructions

Geberit GIS

The creative director

The Geberit GIS installation system allows a quick and easy frame installation, which supports all kinds of sanitary ware from washbasins to toilets. With Geberit GIS there are no limits to creative opportunities. Regardless of whether it's a new building project or the modernisation of an existing bathroom. For example you can place the toilet against a new partition wall that is creatively dividing space.

The advantages of Geberit GIS:

- Individual assembly on-site
- Prefabrication of whole units possible
- New creative possibilities for your bathroom
- For dry wall constructions

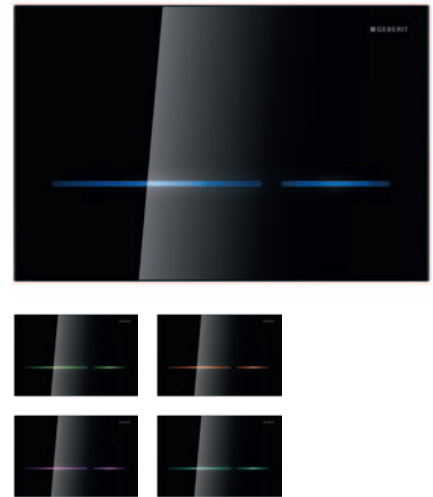
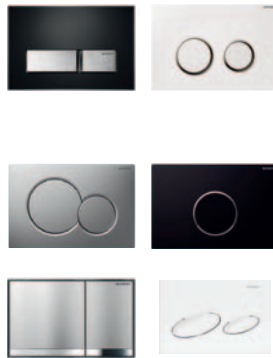

Geberit DuoFresh

Pure air

The new Geberit DuoFresh WC system brings a breath of fresh air to your bathroom. The secret lies hidden behind the wall. A switch on the actuator plate activates the odour extraction system, which purifies the air using the active carbon filter and releases it back out into the room.

User-friendly

The attractive Geberit actuator plate Sigma40 offers quick and easy access to the very heart of Geberit DuoFresh – in other words, the electronically controlled odour extraction unit and the replaceable active carbon filter, all of which are hidden behind the wall.

Fresh air for your well-being:

- Unpleasant odours are extracted right at their source
- Discreet look thanks to the integration of the odour extraction unit into the concealed cistern
- Maximum ease of use

Geberit actuator

Tangible design

Reliable and attractively designed, Geberit actuator plates come in different styles, flush options, colours and finishes to complement all kinds of bathroom design. They offer functionality that will withstand being pushed time after time. And if you prefer a touchless solution or remote actuation, an integrated infrared sensor flushes the toilet. The remote control can be built into a hand rail to conveniently activate the flush.

Dual flush saves water

Actuator plates for two different amounts of water are our contribution to water saving. Environmental protection is also good for the budget. The dual flush system, with buttons for 3 or 6/9 litres of water, brings real water savings to every household.

Further information on

- www.international.geberit.com/configurator

Geberit Sigma80

Untouchable beauty

Mechanical flushing via a push button is a thing of the past with Geberit Sigma80. By holding the hand in front of the light fields the user initiates the flushing process and actuates either the small or the large flush. The surface of the actuator plate is either black or smoked reflective glass. A stand-by function makes sure that the consumption of electricity is kept down to a minimum.

Reasons for a touchless actuator:

- Button visualisation by means of light fields
- Touchless dual flush
- Suitable for Geberit Sigma concealed cistern 12 cm (UP320) and 8 cm (UP720)
- Can be used in conjunction with Geberit AquaClean
- Self-learning sensor technology
- Option of automatic or interval flush
- Light fields can be set in five colours: blue, turquoise, magenta, orange, yellow

Innovation at its best.

Functional design inclusive.



Geberit Monolith

Solid design

The Geberit Monolith sanitary module can be combined with ceramic appliances from most other manufacturers. In most cases it can be quickly hooked up to existing connections without any structural changes – a real advantage in major renovations. Choose from different colours for the glass front cladding. The Geberit Monolith is also available for Geberit AquaClean 8000/8000*plus*.

Reasons to go for a Geberit Monolith:

- Gentle renovation possible
- A design piece for your bathroom
- Several colours to choose from
- For wall-hung and floor standing WCs

Geberit AquaClean

Only pure water

The Geberit AquaClean is the toilet that cleans you with water. A new kind of personal hygiene that is gentle and natural. It gives you a sense of freshness and cleanliness that you will soon not want to live without. There is a perfect model for every bathroom. The toilet seats are compatible with virtually any toilet, and installation is extremely easy. You can decide for yourself just how much comfort and how many different functions you want from your Geberit AquaClean.

Most private luxury:

- A new level of comfort for your bathroom
- Simple assembly of the toilet seats
- Self-explanatory control panel
- Warm air-drying instead of toilet paper

Geberit shower element

Innovative
wall-drainage

Floor even solutions for showers are getting more and more popular. An alternative to traditional wet room drainage is the Geberit shower element which integrates the drainage into the wall. The drain is not interrupting the floor and this opens up the room. The hair trap can be easily accessed and the removable trap insert makes cleaning quick and easy.

Floor heating can be installed without any interruption underneath the floor of the shower.

Disappearing in the wall:

- Never standing on the drain again
- More freedom in your bathroom design
- Classy and highly functional design
- Easy cleaning



Geberit shower channel

Stylish space opener

The Geberit shower channel is an alternative finishing touch for floor even showers. The channel is fixed to the floor with adjustable feet. No tools are required. The height, inclination and offset of the frame can be adjusted to suit the thickness and size of tiles, the incline and the tile grid.

There is the possibility to customise the cover with the tiles of your floor, which makes the channel literally disappear.

Crossing the channel:

- Two positions for the installation: in the room centre or at the wall
- Height is adjustable
- Beautiful design for a modern bathroom



Geberit traps

For the perfect flow

Geberit traps for washbasins are shaped for optimised flow. Among other things, Geberit uses computer-animated simulation technology in the continuous development of products. The traps for washbasins therefore offer a high discharge rate as well as a considerable self-cleaning effect which prevents clogging.

Geberit offers a comprehensive range of attractive traps for washbasins with Geberit direct traps, Geberit concealed traps and classic Geberit P-traps.

Beautifully functional:

- Elegant design
- Self-cleaning
- High discharge rate



Geberit bathtub drains

Function in top shape

Geberit bathtub drains ensure simple, safe and tension-free installation in almost any construction situation. The Geberit traps are shaped for optimised flow, thus ensuring a high discharge rate and very good self-cleaning effect.

The Geberit push-button actuation PushControl opens and closes the bathtub drain. This makes operation easier, more convenient and more comfortable for the user. Thanks to the push-button mechanism, the bathtub overflow has an ultra-flat profile, ensuring nothing interrupts the smooth inner surfaces of your bathtub.

Complete range for any bathroom:

- Various dimensions and colours available
- Self-cleaning
- Quick drainage

A touch of perfection.

Public areas hands-free.

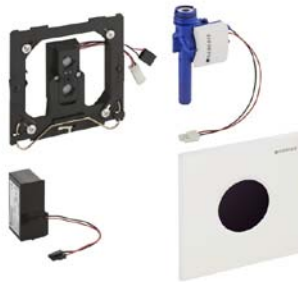

Geberit taps

Touchless technology

Geberit offers elegant infrared and self-closing taps, which are available with or without a mixer, all keeping actual physical contact to a minimum. The water flows only when actually needed, i.e. hands are detected under the tap. This leads to a significant reduction in the consumption of water. The taps are programmed via a remote control. Like this the danger to damage the components by manual adjustment are kept to a minimum.

Tap dance:

- Easy maintenance
- Water saving
- Very hygienic
- Vandal-proof
- For mains or battery operation

Geberit urinal and WC controls

Intelligent flushing

Geberit urinal and WC controls detect the presence of the user with short-wave infrared emissions and activate the automatic flush immediately after each use. The sensor is protected by a highly resistant and yet elegant cover. In addition to the flushing after use, automatic flushes can be programmed at set intervals to avoid stagnation in the toilet and pipes. This means that for every given set of circumstances it is possible to find the optimal balance of hygiene and economy of water consumption.

Physical contact reduced to the max:

- Programmable flushing
- Water saving
- Hygienic
- Elegant design
- Vandal-proof
- No need for fragrance blocks anymore

Self Sustainable Power Supply

Geberit's power station

A small generator in the supply pipe makes the touchless Geberit taps independent from the electrical power supply or battery power. Whenever the tap is in use, the flowing water charges the hydroelectric turbine which produces electricity. The electricity produced is stored in a rechargeable battery that makes sure that the tap is operational at any time. This system reduces the ecological impact down to 50% compared to the use of batteries and 80% compared to an electrical connection. The ideal solution for sustainable projects.

Hydropower plant.

Sustainable power
and water savers.

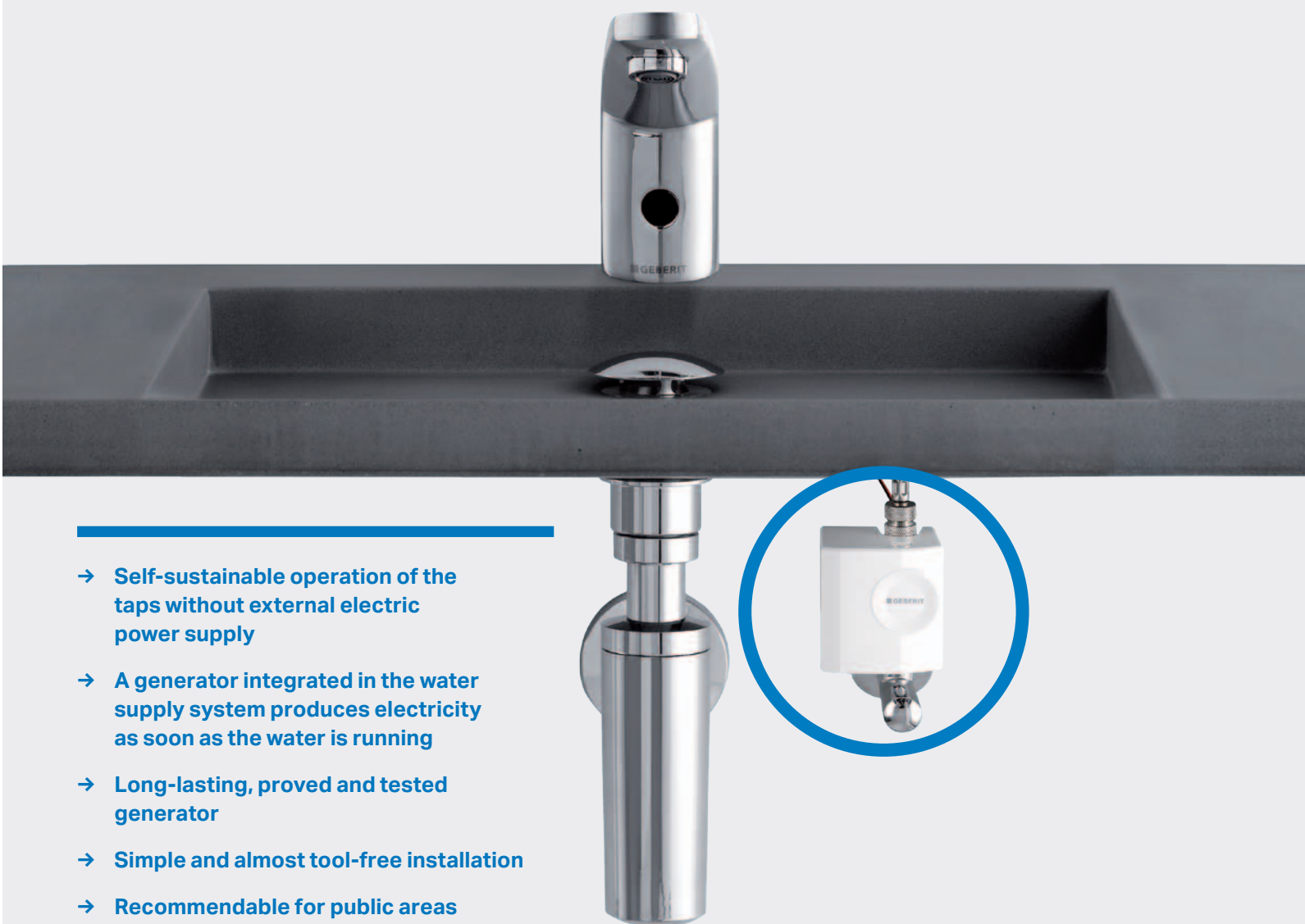

- Self-sustainable operation of the taps without external electric power supply
- A generator integrated in the water supply system produces electricity as soon as the water is running
- Long-lasting, proved and tested generator
- Simple and almost tool-free installation
- Recommendable for public areas
- High-end rechargeable battery technology
- Sustainable solution

Draining at the highest stage.

The Geberit waste and drainage systems.

Waste & Drainage

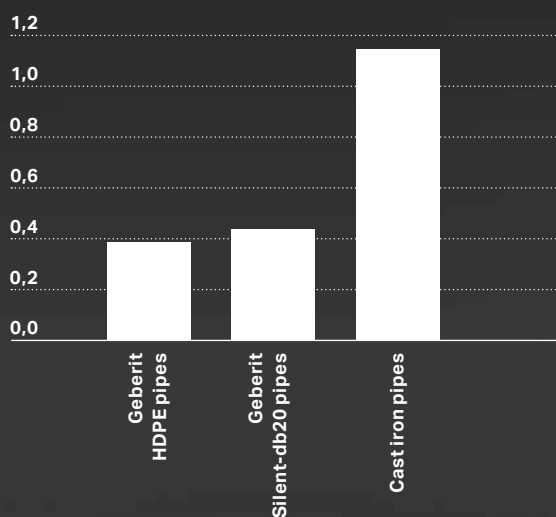

Environmental impact of pipe systems in comparison, measured in eco-indicator points (EIP99) of the Dutch ecobalance method.



Draining waste water. Geberit's piping system.



Geberit HDPE The multi-purpose solution

The Geberit HDPE drainage system delivers optimal performance. The system pipes are easily welded and guarantee not only high chemical, thermal and mechanical strength but are also absolutely watertight and possess an extraordinarily high longitudinal strength. Geberit HDPE pipes can even be installed in concrete. Geberit HDPE is ideal for prefabrication. With the majority of work carried out in the workshop, the installation requires just a few simple connections on-site. The light weight of HDPE pipes allows the transport of full assemblies from the workshop to where they are required.

Reasons to choose Geberit HDPE:

- Resistant to impact and highly flexible
- Completely leak-proof
- Resistant to chemicals and high temperatures
- Wide range of diameters
- Cast in concrete possible
- Easy to prefabricate away from site

Geberit Sovent High-rise innovation

The Geberit Sovent fitting has been developed for high-rise buildings. The specially designed branch inlet fitting reduces the pneumatic pressure fluctuations in stacks preventing the syphonage of traps. The aim of the development was to substantially increase the performance of a soil and waste drainage system, and thus to eliminate a separate vent stack and reduce the diameter of the stacks in high-rise buildings.

This versatile drainage system with the engineered design offers an economical and high-performance alternative to conventional drainage systems.

Geberit Sovent competencies:

- Best solution for high-rise buildings
- Multiple joint solution
- Increased stack capacities
- Compatible with Geberit HDPE & Silent-db20
- Economic alternative to conventional discharge stacks

Geberit Silent-db20 Muted sounds

Geberit Silent-db20 has very good soundproofing properties because of its significantly increased mass. The product is made of mineral reinforced HDPE. The material is UV-resistant due to 2% soot, recyclable, can be welded with Geberit HDPE and its chemical characteristics are like HDPE.

The ribs have a vibration dampening effect and reduce the vibration of the pipe and therefore the emission of airborne sound.

The sound of silence:

- The Geberit Silent-db20 has the same qualities like Geberit HDPE
- Outstanding sound insulation
- System with numerous dimensions and fittings
- Hydraulically optimised fittings
- Safe and permanent connection

The Geberit roof drainage system.

The effective rain solution.

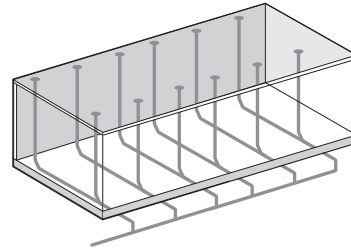

↑ Conventional roof drainage system

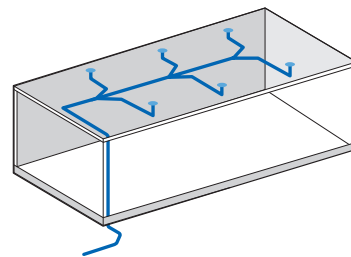

↑ Geberit Pluvia syphonic roof drainage system

Geberit Pluvia

Not afraid of cats and dogs

The Geberit Pluvia roof drainage system includes roof outlets, pipes and fittings made of Geberit HDPE. Unlike conventional roof drainage methods, the Geberit Pluvia system functions as a syphonic system. The pipeline fills completely as rapidly as possible and creating a negative pressure. The water is drawn away by suction and not allowed to drain away constantly. This also ensures an improved self-cleaning function.

The system is cost-effective as smaller pipe diameters can be applied and the Geberit Pluvia system uses significantly fewer stacks and less underground pipes. The Geberit Pluvia roof outlets are linked together directly under the roof with a non-sloping collector pipe. Large roof areas can therefore be drained through a single discharge stack.

This simplifies planning and reduces construction time, and it enables planners and architects to go new ways in planning and development of drainage solutions.

There is a wide range of Geberit Pluvia outlets available, allowing the connection with every roof material. They can also be transformed into emergency outlets with an additional installation kit.

10 good reasons to go for Geberit Pluvia:

- Wide range of applications
- Space-saving
- Less downpipes
- Cost-saving installation
- Less work on-site
- Functions as a syphonic system
- Large areas can be drained through a single discharge stack
- Small pipe diameter
- Less underground pipes, less manholes
- Outlets for all roof types

Staying high and dry. Clever roof drainage.

-
- Over 35 years of experience
 - For roofs of factories, warehouses, shopping centres, airports, hotels, sport centres, etc.
 - High reliability and outstanding durability
 - Low system weight
 - Discharge of up to 25 litres of rainwater per second



Water, simply connected.

Geberit supply systems.

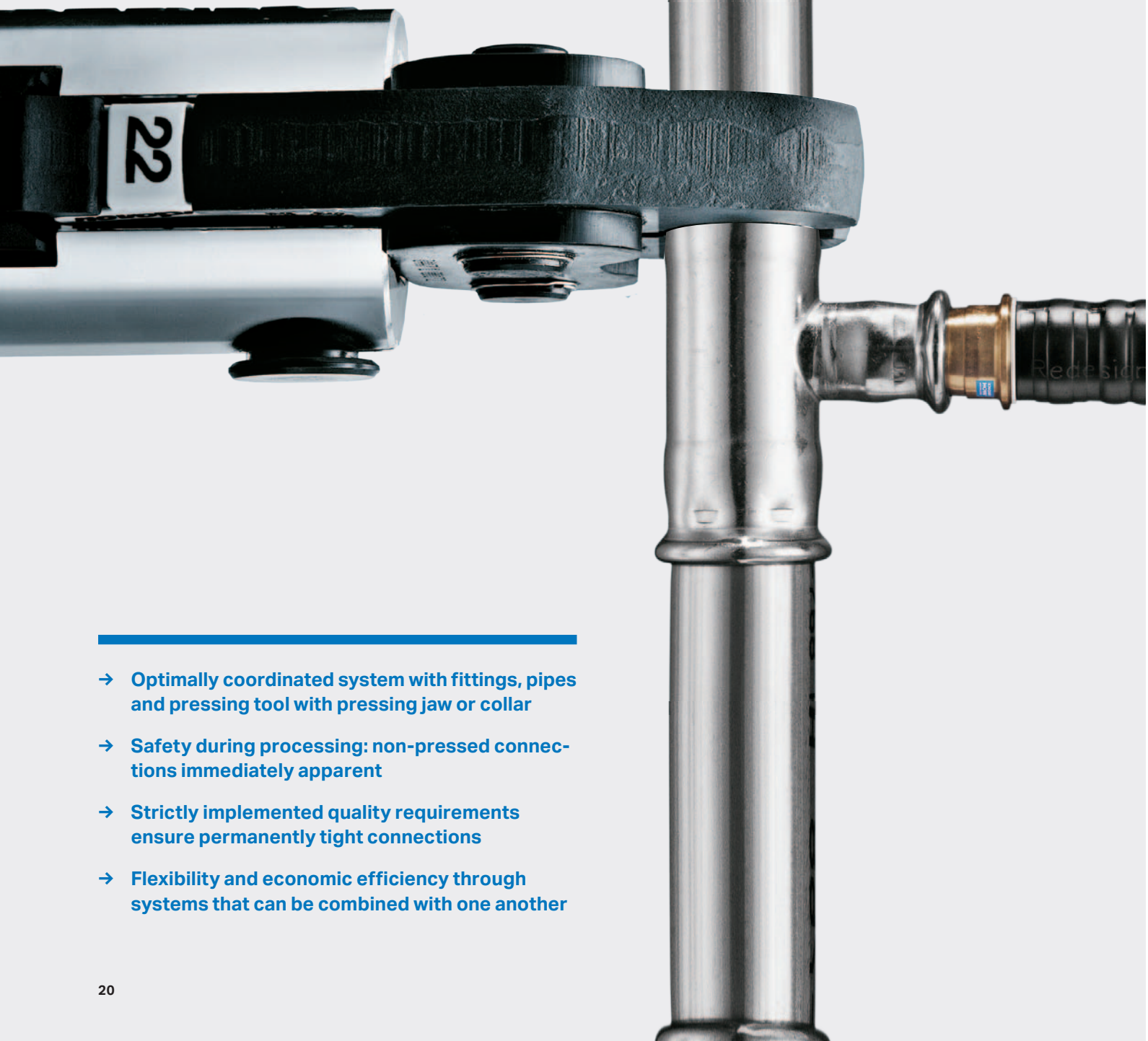

-
- **Optimally coordinated system with fittings, pipes and pressing tool with pressing jaw or collar**
 - **Safety during processing: non-pressed connections immediately apparent**
 - **Strictly implemented quality requirements ensure permanently tight connections**
 - **Flexibility and economic efficiency through systems that can be combined with one another**

Geberit Mapress and Geberit Mepla. Simply connected.



Don't stress. Press. Easy assembling

Safe and long-lasting connections are the primary goal in all areas of pipe installation. In addition, a quick and easy installation is important to the plumber. The pressing systems Geberit Mapress and Geberit Mepla meet these requirements perfectly. Transitions between different product materials and systems can be realised without any problems thanks to the numerous adapters. For example, in heating installations, Geberit Mapress Carbon Steel can be used for the basement distribution and the riser pipe and the Geberit Mepla multilayer pipe system for the radiator connection – no need for complicated sealing with hemp or the use of a threaded adapter. Just insert, press, done.

Geberit Mapress The allround talent

When it comes to hygiene, temperature, pressure or aggressive liquids, you will always make the right decision by choosing Geberit Mapress Stainless Steel, which has proven its worth well, not only in domestic installations, but also in industrial plants. Geberit Mapress Stainless Steel has obtained VdS approval as well as all relevant international approvals for use in sprinkler systems.

The allround talent:

- For extreme requirements in terms of drinking water hygiene and a high load bearing capacity
- Chemical and thermal disinfection possible
- Can be used for a multitude of media using the corresponding seal rings
- Pressing indicator identifies non-pressed connections even before the pressure test
- Large assortment: 11 dimensions from 12 to 108 mm, roughly 500 fittings
- System compatibility with Geberit Mepla and the other Geberit Mapress product materials

Geberit Mepla The versatile option

The Geberit Mepla multilayer pipe, which consists of an inner pipe made of PE-Xb, an aluminium pipe and a protective HDPE layer on the outside, allows for easy, safe and flexible processing, whilst also complying with high hygiene standards. The fittings ensure a high degree of safety during processing as well as reliable tightness. These characteristics make Geberit Mepla especially suited to drinking water supply and radiator connections.

Fast and flexible:

- Inherently stable, flexible and corrosion-resistant
- Non-pressed connections are visibly leaky
- High resistance to pressure
- Pipes and fittings hygienically sealed
- Can be chemically and thermally disinfected
- Suitable for any drinking water quality
- Adapters for all Geberit installation elements
- Adapters for quick connections to Geberit Mapress

Applying knowledge forms values.

- Geberit owns 25 education centres worldwide
- Every year approximately 30,000 plumbers, architects and planners are trained on Geberit systems and software
- Geberit is interested in passing on knowledge and a vivid exchange of experience
- Success at the international level is a matter of dialogue
- Geberit relies on partnership in business relations and fairness in interaction with competitors and associations



Geberit International Sales AG
CH-8640 Rapperswil
Switzerland

sales@geberit.com

→ www.international.geberit.com



Further information to current products.

→ www.international.geberit.com